

KHZ SMD CRYSTAL

MAIN FEATURE

- KHz SMD Crystal, Metal Lid • Typical Load Capacitance: 12.5pF

RFQ
Request For Quotation

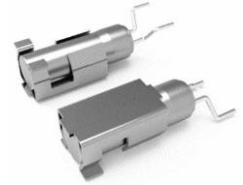

APPLICATION

- Clock source for Portable and more



Ø2.0*L6.0mm

STANDARD SPECIFICATION

| Parameter | Value | | | Unit | Condition |
|------------------------------|----------|--------|-------|--------------------|-------------------|
| | Min. | Type | Max. | | |
| Frequency Range | 25.6 | 32.768 | 307.2 | KHz | |
| Oscillation Mode | AT Fund. | | | | |
| Frequency Tolerance | ±10 | ±20 | ±30 | ppm | @25 °C or Specify |
| Operating Temperature Range | -40 | - | +85 | °C | |
| Storage Temperature Range | -55 | - | +125 | °C | |
| Load Capacitance (CL) | 6 | 12.5 | 30 | pF | |
| Frequency/Temp Coefficient | -0.04 | -0.034 | 0.04 | ppm/C ² | |
| Turnover Temp | +20 | +25 | +30 | °C | |
| Equivalent Series Resistance | 35 | - | 50 | Kohm | |
| Drive Level | - | - | 1.0 | µW | |
| Shunt Capacitance | 0.9 | 1.35 | 2.0 | pF | |
| Dynamic Capacitance | - | 2.3 | - | Ff | |
| Quality Factor | | 60000 | 75000 | | |
| Capacitance Ratio | - | 450 | - | | |
| Aging per year | - | ±5 | | ppm/year | |
| Insulation Resistance | 500 | - | - | Mohm | @ 100Vdc ± 15V |

PART NUMBER GUIDE

Example: CCMA 32K768A20-12.5-40-50 THF

| | | | | | | | | | |
|------|--------|---|----|-------|-----|-----|---|----|----|
| CCMA | 32K768 | A | 20 | -12.5 | -40 | -50 | T | LH | XX |
| 1 | 2 | 3 | 4 | 5 | 6 | 7 | 8 | 9 | 10 |

1. CCMA: KHz SMD Crystal, L1.6*W1.0*H0.5mm
2. 32K768: Frequency Range 32.768KHz
3. A: Oscillation Mode, A: AT Fund.
4. 20: Freq. tolerance, 20: +/-20ppm
5. 12.5: Load Capacitance(CL), 12.5: 12.5pF or Specify CL value
6. 40: Operating Temp. Range, 40: -40°C ~+85°C
7. 50: Equivalent Series Resistance (ESR), 50: 50 Kohm Max.
8. T: Package in Tape/Reel, 3000pcs/Reel
9. LH: RoHS/RoHS III compliant, RoHS Annex III lead Exemption (exempt per RoHS EU 2015/863)
10. XX: Intenal Control Code, 2 letter or digits; Blank: N/A

DIMENSION (Unit: mm)

Top View

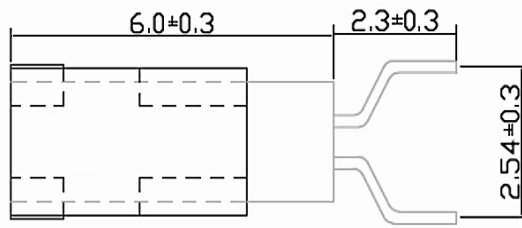

Bottom View



Side View

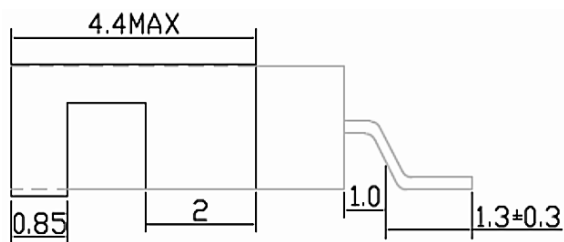

**Recommend
Pad Layout**

